

Reusable



molabolt[®]
BY ADVANCED BOLTING SOLUTIONS

The Molabolt

The innovation behind the Molabolt is its ability to expand to provide a firm bite that does not rely on a good thread or being tightly fitted.

The Molabolt has a wide range of uses.

It's core benefits are:

- Speed and ease of use. It will save hours and no special skills are required
- It's ideal for fitting to poor or damaged thread
- It's completely universal working with any thread

PERMALOK
FASTENING SYSTEMS LIMITED
DN11 8EW
TEL : 01302 711308
FAX : 01302 719823

**THE FASTEST
FIT TO ANY
THREAD**

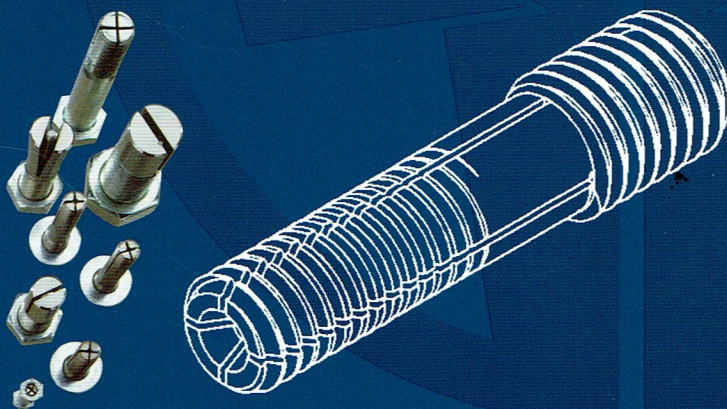

Threaded Bypass Bolt

To be used where recipient threads have become damaged/worn or incomplete; also where contamination has occurred due to rust, paint, plating or where other debris makes the use of a standard bolt impractical or impossible.

The Mola Threaded Bypass Bolt Uses

- Mechanical equipment
- Engineering
- Automotive, transport etc.
- To be used where recipient threads have become damaged, worn, contaminated e.g paint, rust, plating etc.



STEEL CONSTRUCTION

INDUSTRY

TRANSPORT

MAINTENANCE

The bolt that bites

Reusable

Threaded Bypass Bolt



molabolt
BY ADVANCED BOLTING SOLUTIONS



SIZE	GRADE	FINISH	PRODUCT CODE	CLAMP		TENSILE KN	SINGLE SHEAR KN	MAX. TORQUE NM
				Min (mm)	Max (mm)			
M8 x 25	8.8	Zinc/Black	BPP0825	5	9	25	19	10
M8 x 30	8.8	Zinc/Black	BPP0830	10	14	25	19	10
M8 x 45	8.8	Zinc/Black	BP0845	25	29	25	19	10
M10 x 30	8.8	Zinc/Black	BPP1030	5	10	30	29	20
M10 x 45	8.8	Zinc/Black	BPP1045	20	25	30	29	20
M10 x 50	8.8	Zinc/Black	BPP1050	25	30	30	29	20
M10 x 60	8.8	Zinc/Black	BPP1060	30	35	30	29	20
M12 x 50	8.8	Zinc/Black	BPP1250	20	26	45	42	50
M12 x 60	8.8	Zinc/Black	BPP1260	30	36	45	42	50
M12 x 70	8.8	Zinc/Black	BPP1270	40	46	45	42	50
M14 x 50	8.8	Zinc/Black	BPP1450	15	22	55	49	95
M14 x 60	8.8	Zinc/Black	BPP1460	25	32	55	49	95
M14 x 70	8.8	Zinc/Black	BPP1470	35	42	55	49	95
M16 x 50	8.8	Zinc/Black	BPP1650	10	18	75	55	140
M16 x 60	8.8	Zinc/Black	BPP1660	20	28	75	55	140
M16 x 70	8.8	Zinc/Black	BPP1670	30	38	75	55	140
M16 x 80	8.8	Zinc/Black	BPP1680	40	48	75	55	140

THE BOLT HAS BEEN REBORN

PLEASE NOTE:

ALL STUDS MUST HAVE A MINIMUM THREAD ENGAGEMENT OF AT LEAST THE BOLT DIAMETER.

EXAMPLE:

M16 STUD = 16mm THREAD ENGAGEMENT

Mola Threaded Bypass Bolt Fitting Guide

- 1 Choose stud of correct length and diameter
- 2 Pass stud into components
- 3 Strike pin flush with a suitable hammer or allen key depending on stud type
- 4 With stud fully home tighten to recommended torque (see guide)

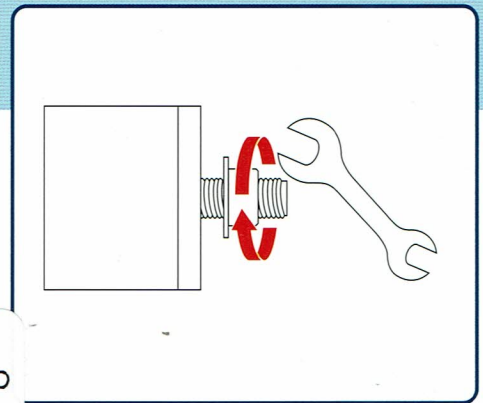
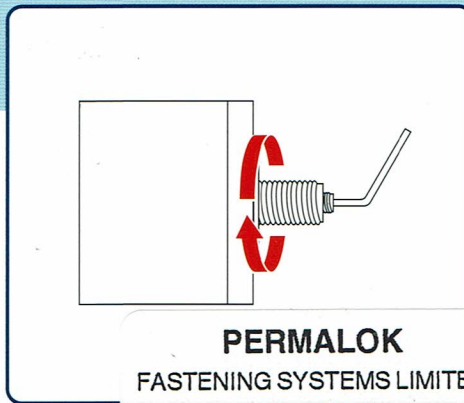
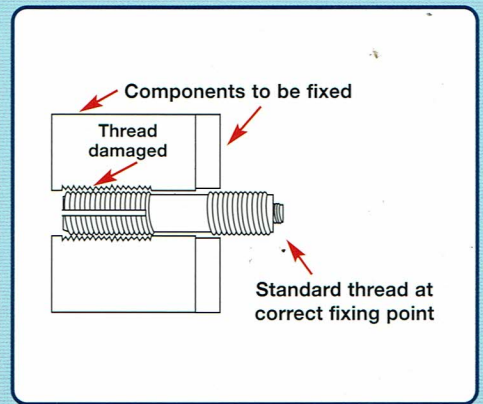
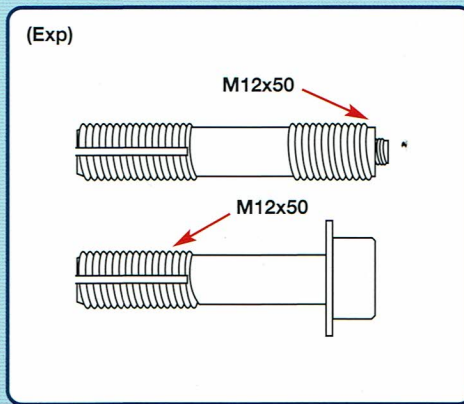
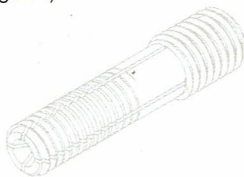

PERMALOK
FASTENING SYSTEMS LIMITED
DN11 8EW

TEL : 01302 711308
FAX : 01302 719823

